

The copyright of this drawing is owned by FRICON.
The drawing shall not be reproduced or its contents disclosed to a third without written permission from FRICON.

\\172.24.15.201\Desenho\02-GELADOS E CONGELADOS\C04 - COMUNS HCE\CO-COMERCIAL\DRAWING 2D\AUTOCAD

General linear tolerance

Dimensions	0.5 ... 3	>3 ... 120	>120 ... 1000	>1000 ... 4000
Deviation (mm)	±0.2	±0.5	±1	±2

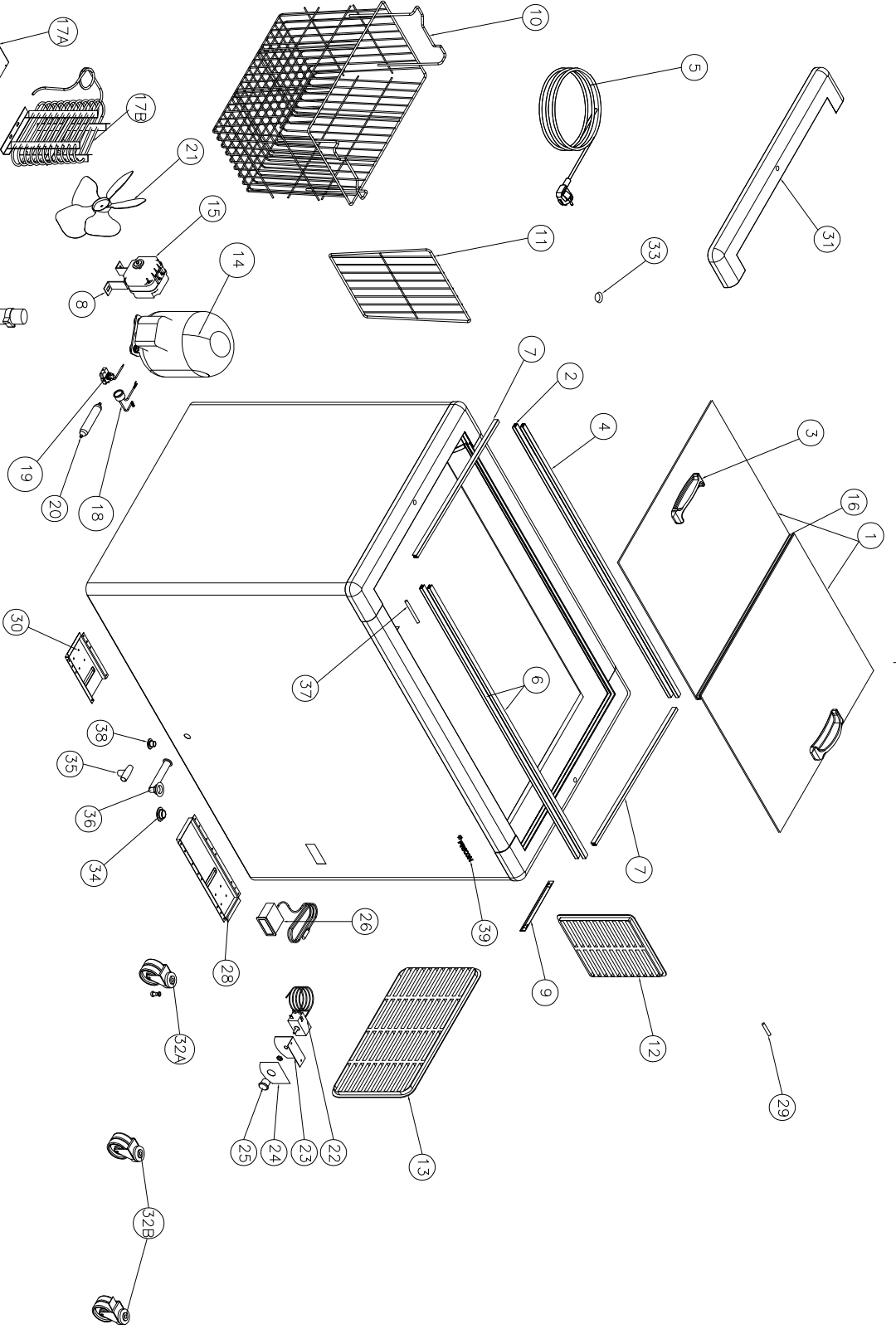

Verified										
Verified date										
Designer	André Silva									
Drawer date	29/04/2021	Rev.	Change	Date	Designer					
Scale	SE	DIN	A4							
Part Code		CNC Program								
Material										
Thickness										
Project	HCE	Description	DESENHO EM EXPLOSAO HCE 65G 230-50HZ Drawing code CO 02 C04 015							

1 2 3 4 5 6

1 2 3 4 5 6

A B C D

Equipment Model: HCE 6SG 230V/50HZ				Updated:	
Drawing Number: CO 02 C04 015				06/08/2021	
N°	Code	Description	Quantity	Unit	
1	09.2716	GLASS COVER 575 X 481MM	2	UN	
1+	C09.2716	GLASS COVER 575 X 481MM WITH HANDLE	1	UN	
2	01.1491	INFERIOR PROFILE 862MM	1	UN	
3a	511.0288	HCE HANDLE	2	UN	
3a+	C511.0288	HCE HANDLE WITH SCREWS	1	UN	
3b	511.1063	HANDLE	2	UN	
3b+	C511.1063	HANDLE WITH SCREWS	1	UN	
4	01.1496	SUPERIOR PROFILE 862MM	1	UN	
5	03.0007	POWER CABLE 3G0,75MM TYPE-E/F	1	UN	
6	01.0903	LID SLID PROFILE 942MM	2	UN	
7	01.1455	LID SLID PROFILE 583MM	2	UN	
8a	09.1696	FAN MOTOR SUPPORT 52MM	1	UN	
8b	09.0988	FAN MOTOR SUPPORT 72MM	1	UN	
9	07.0864	LEVEL CHARGE LABEL	1	UN	
10	513.0088	HORIZONTAL BASKET 270	OPCIONAL	UN	
11	513.0089	BASKET 270 DIVIDER	OPCIONAL	UN	
12	511.0043	BACK GRID	1	UN	
13	511.0007	PLASTIC SIDE GRID	1	UN	
14a	02.0537	EMBRACO EMC3119U COMPRESSOR 230V/50HZ (R290)	1	UN	
14b	02.0487	EMBRACO EMYE70HEP COMPRESSOR 230V/50-60HZ (R134)	1	UN	
15a	02.0602	HIGH EFFICIENCY NIQ MOTORFAN	1	UN	
15b	02.0343	FAN MOTOR 5W 230V 50-60HZ	1	UN	
16	01.1693	LID SEAL PROFILE	2	UN	
17a	02.0584	WIRE ON TUBE CONDENSER	1	UN	
17b	02.0031	22 TURNS CONDENSER	1	UN	
18a	02.0615	EMBRACO EMC3119U COMPRESSOR'S OVERLOAD PROTECTOR	1	UN	
18b	02.0545	EMBRACO EMYE70HEP COMPRESSOR'S OVERLOAD PROTECTOR	1	UN	
19a	02.0381	EMBRACO EMC3119U COMPRESSOR'S RELAY	1	UN	
19b	02.0551	EMBRACO EMYE70HEP COMPRESSOR'S RELAY	1	UN	
20	02.0565	7,5G FILTER IN-5/OUT-3 (R290/R600)	1	UN	
21a	02.0079	ASPIRANT HELIX Ø200MM 28°	1	UN	
21b	02.0341	ASPIRANT HELIX Ø172MM 28°	1	UN	
22	03.0233	THERMOSTAT THG/HCE	1	UN	
23	515.0174	SHEET METAL THERMOSTAT SUPPORT	1	UN	
24	07.0010	THERMOSTAT LABEL	1	UN	
25	511.0006	THERMOSTAT BUTTON	1	UN	
26a	03.0028	ANALOGIC THERMOMETER CELCIUS DEGREES	1	UN	
26b	03.0217	ANALOGIC THERMOMETER FAHRENHEIT DEGREES	1	UN	
27a	02.0409	EMBRACO EMC3119U COMPRESSOR'S RUN CAPACITOR	1	UN	
28a	515.0037	BIG SUPPORT FOR RECTANGULAR PLATE CASTER FIXING	2	UN	
28b	515.0055	BIG SUPPORT FOR CASTER WITH M10 FIXING HOLE	2	UN	
29	511.0990	LID STOP 9.8X11MM	2	UN	
30a	515.0036	SMALL SUPPORT FOR RECTANGULAR PLATE CASTER FIXING	2	UN	
30b	515.0054	SMALL SUPPORT FOR CASTER WITH M10 FIXING HOLE	2	UN	
31	01.1605	REPLACEMENT PLASTIC	2	UN	
31+	C01.1605	REPLACEMENT PLASTIC WITH COVERS	1	UN	

ACCESSORIES LIST

Equipment Model: HCE 6SG 230V/50HZ			Updated: 06/08/2021	
Drawing Number: CO 02 C04 015				
N°	Code	Description	Quantity	Unit
32a	09.2537	CASTER 88/NS-50X28 F4-2	4	UN
32b	09.2786	CASTER WITHOUT BRAKE	2	UN
	09.2787	CASTER WITH BRAKE	2	UN
33	511.0896	PLASTIC COVER HCE	2	UN
34	511.0105	WHITE INTERIOR DRAIN PLUG	1	UN
35	511.0107	DRAIN PURGE	1	UN
36	511.0208	WHITE DRAIN PIPE	1	UN
37	511.0939	HCE LID STOP	2	UN
38	511.0825	WHITE EXTERIOR DRAIN PLUG	1	UN
39	07.0818	"FRICON" STICKER	1	UN