

WARING COMMERCIAL®

Europe Xtreme Blenders with Electronic Membrane Keypad and a 30 Second Electronic Countdown Timer with a 48 oz. Stackable Raptor Container

MX1100XTPEE MX1100XTPSEE

with Sound Enclosure

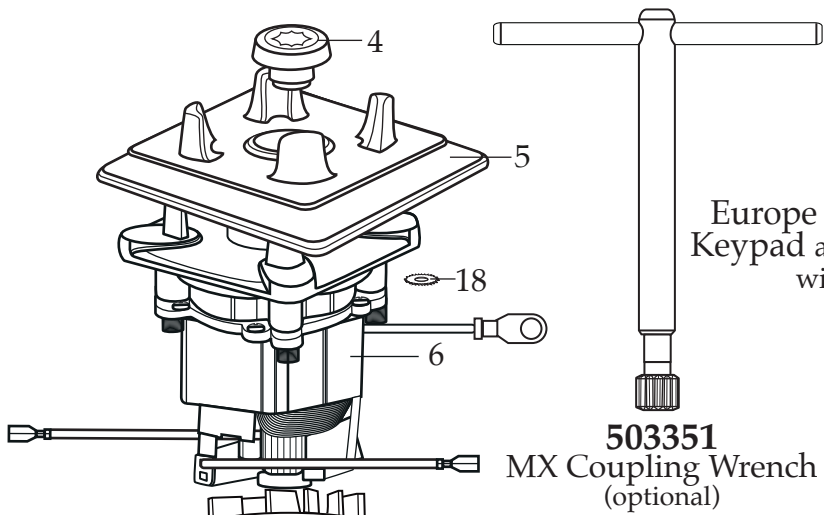

503351
MX Coupling Wrench
(optional)

036743
Brush/Spring
(2 required)

Sealant all round threads, fill in flats.

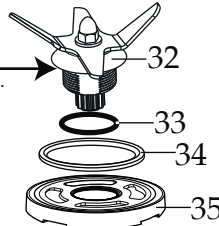

030889
Blending Assembly Kit
(with 503397)

031060
Blending Assembly Kit
(with 503345)

Notes for 503439:

Torque 100-125 in./lbs
Sealant all around the threads, fill in flats.
Dow Corning Sealant RTV 733



Date Code Location
YY|MM|DD
year|month|month|day|day

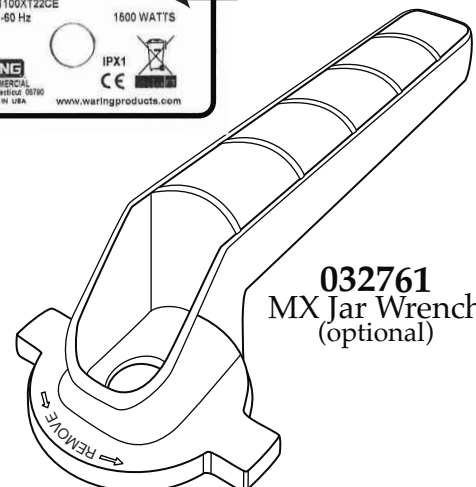

032761
MX Jar Wrench
(optional)

Catalog	Model	
MX1100XTPEE	MX1100XT21CE	MX1100XT21EE
MX1100XTPSEE	MX1100XT22SCE	MX1100XT22SEE
<i>(on units after 7/29/2009)</i>		



Illustration#	Part#	Description
1	028769-E 028769 026425	Jar Lid Cover <i>(changed after 8/25/2010)</i> MX/TBB Eastman Jar Lid Cover <i>(use 028769-E on units after 7/29/2008)</i> MX Eastman Jar Lid Cover <i>(use 026425-E)</i>
2	028768 026424	MX-XT Jar Lid <i>(on units after 7/29/2008)</i> MX Vinyl Jar Lid <i>(use 026424-V)</i>
3	030888 503439 503348 503374 503010	48 oz. Stackable Container ONLY <i>(changed after 8/25/2010)</i> 48 oz. Stackable Container Assembly <i>(on units after 3/18/2014)</i> 48 oz Eastman Container Assembly <i>(on units after 2/24/2011 use 503349)</i> 48 oz Jar with Blending Assembly <i>(on units after 8/25/2010)</i> <i>(use 503309) - 503309 (use 503348) - 503348 (use 503439)</i>
4	503601 028538	Drive Coupling <i>(on units after 1-7-2021)</i> Drive Coupling
5	026442	Jar Pad
6	035398 028823	Leili Motor without Sensor <i>(on units after 7/21/2017)</i> ECM Motor without Sensor
7	026437	Dampening Plate Gasket
8	503382-E-67 503382-E	MX Housings, Ferrite Core & Cord <i>(on units after 7/21/2017)</i> MX Housings, Ferrite Core & Cord <i>(on units after 8/22/2012)</i>
9	028541	Motor Foam (2 required)
10	026439	Dampening Plate Bushing (4 required)
11	026453	Dampening Plate Sleeve (4 required)
12	026459	Washer (2 required)
13	028929	Sems (4 required)
14	036399 029815	Control Panel with Interlock <i>(on units after 6/21/2018)</i> Soft Start Control Panel <i>(changed after 8/22/2012 use 036339)</i>
15	028248	Top Housing Foam Rear Baffle
16	028249	Top Housing Foam Front Baffle
17		<i>Motor Housing Included with Illustration # 8</i>
18	002943	Washer (3 required)
19	028247	Bottom Housing Foam Baffle
20	028542	Foam Baffle
21	013731	Cable Tie (3 required <i>on units after 9/22/2008</i>) – (2 required)
22		<i>Cord Included with Illustration # 8</i>
23	007556 035384 007556	Strain Relief <i>(changed after 6/21/2018)</i> Strain Relief <i>(on units after 4/1/2016)</i> Strain Relief
24	034900	PCB Cushions (4 required <i>on units after 7/18/2019</i>)
25	037232	Flat Neoprene Washer (2 required <i>on units after 7/18/2019</i>)

Catalog

MX1100XTPEE MX1100XT21CE MX1100XT21EE
MX1100XTPSEE MX1100XT22SCE MX1100XT22SEE

(on units after 7/29/2009)

Model

Waring Factory Service Center
314 Ella T. Grasso Ave.
Torrington, CT 06790
Tele. 1-800-269-6640

Fax 860-496-9017
www.waringcommercialproducts.com

Illustration#	Part#	Description
26	037007	PCB Mounting Bracket (2 required <i>on units after 7/18/2019</i>)
27	013768	Screw (2 required <i>on units after 7/18/2019</i>)
28		<i>Bottom Housing Included with Illustration # 8</i>
29	012505	Screw (4 required)
30	026430	Corner Post (4 required)
31	028928	Sems (4 required)
32	503397 503345	Blade Assembly (<i>on units after 3/18/2014</i>) Blade Assembly
33	024271	O Ring
34	024268	Nut Gasket
35	029631	Bearing Holder Nut

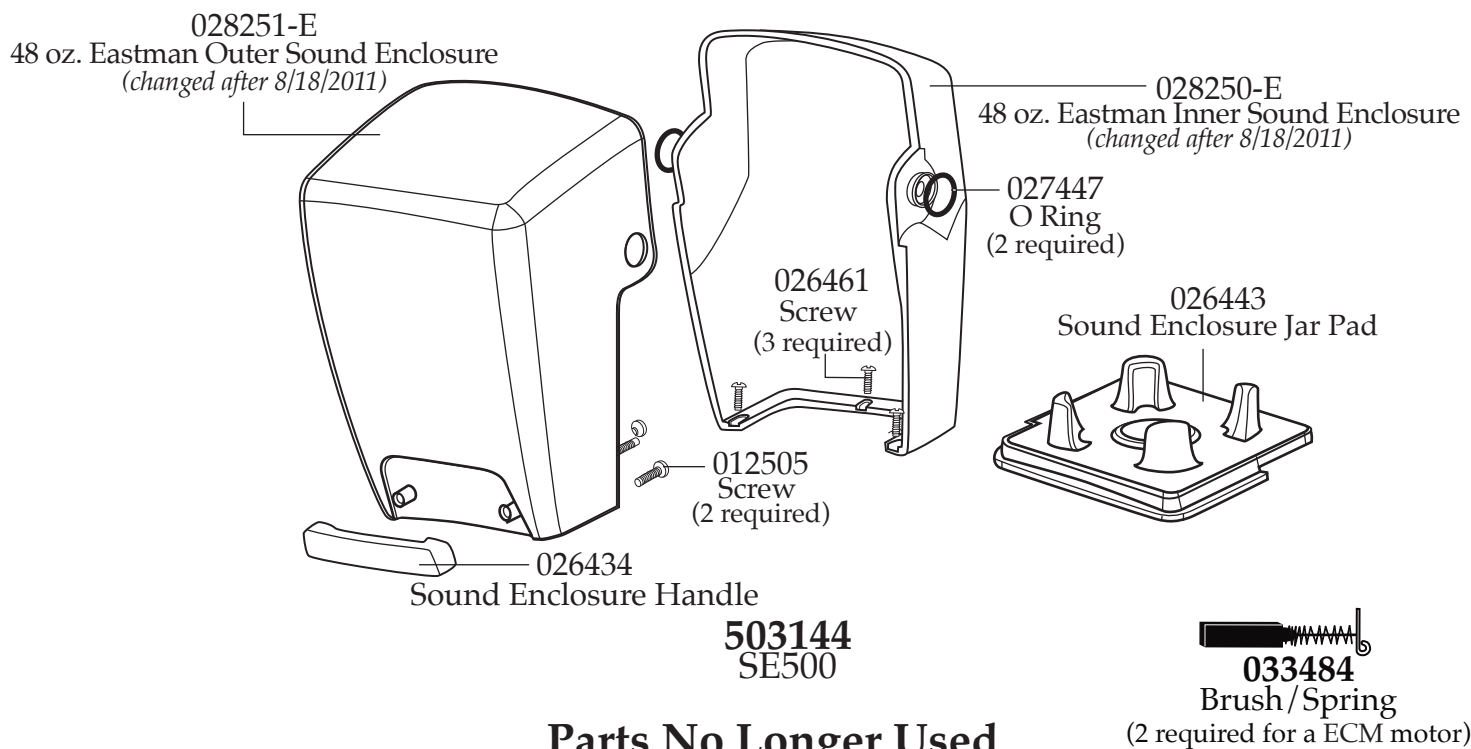

Parts No Longer Used

(Last used on 8/22/2012)

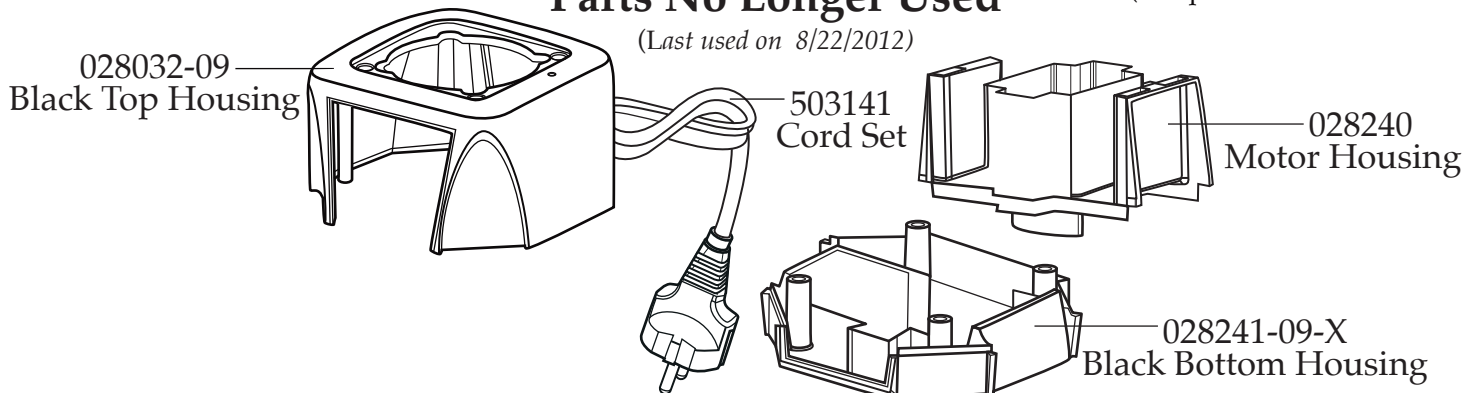

Catalog

MX1100XTPEE MX1100XT21CE MX1100XT21EE
 MX1100XTPSEE MX1100XT22SCE MX1100XT22SEE

(on units after 7/29/2009)

Model

Waring Factory Service Center
 314 Ella T. Grasso Ave.
 Torrington, CT 06790
 Tele. 1-800-269-6640

Fax 860-496-9017
www.waringcommercialproducts.com

Wiring Diagram
 (on units after 8/22/2012)

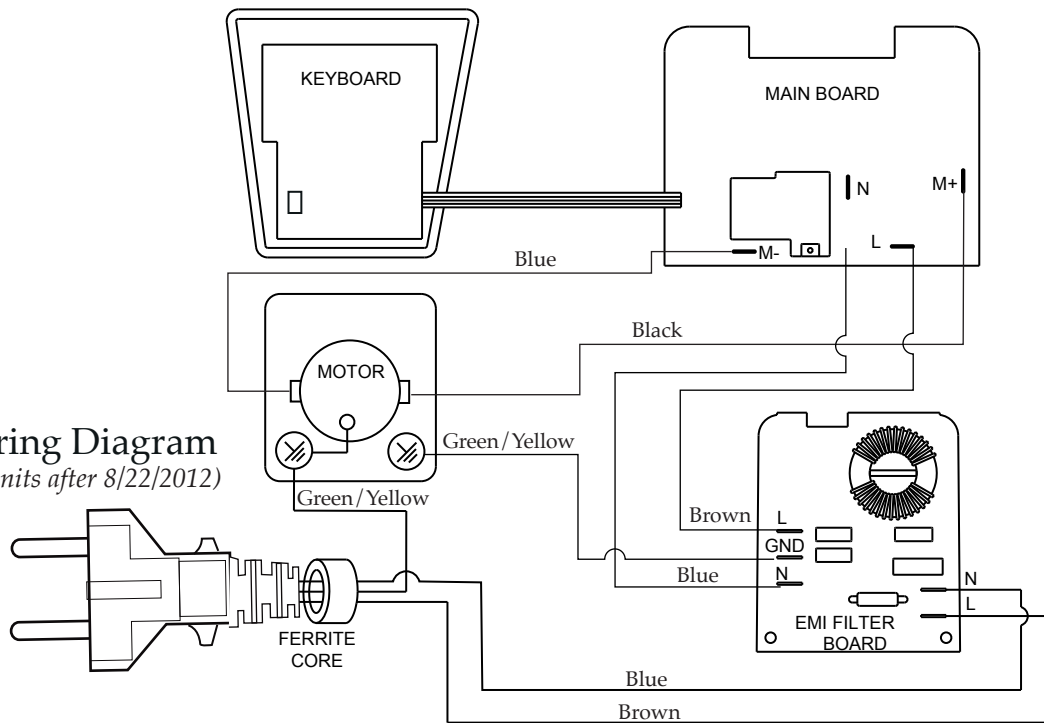

Wiring Diagram

